



# 333 WASHINGTON STREET

## Boston, Massachusetts 02108



**Basement Space For Sale or Lease**

**333 Washington Street Basement Level**  
**Locus Map**

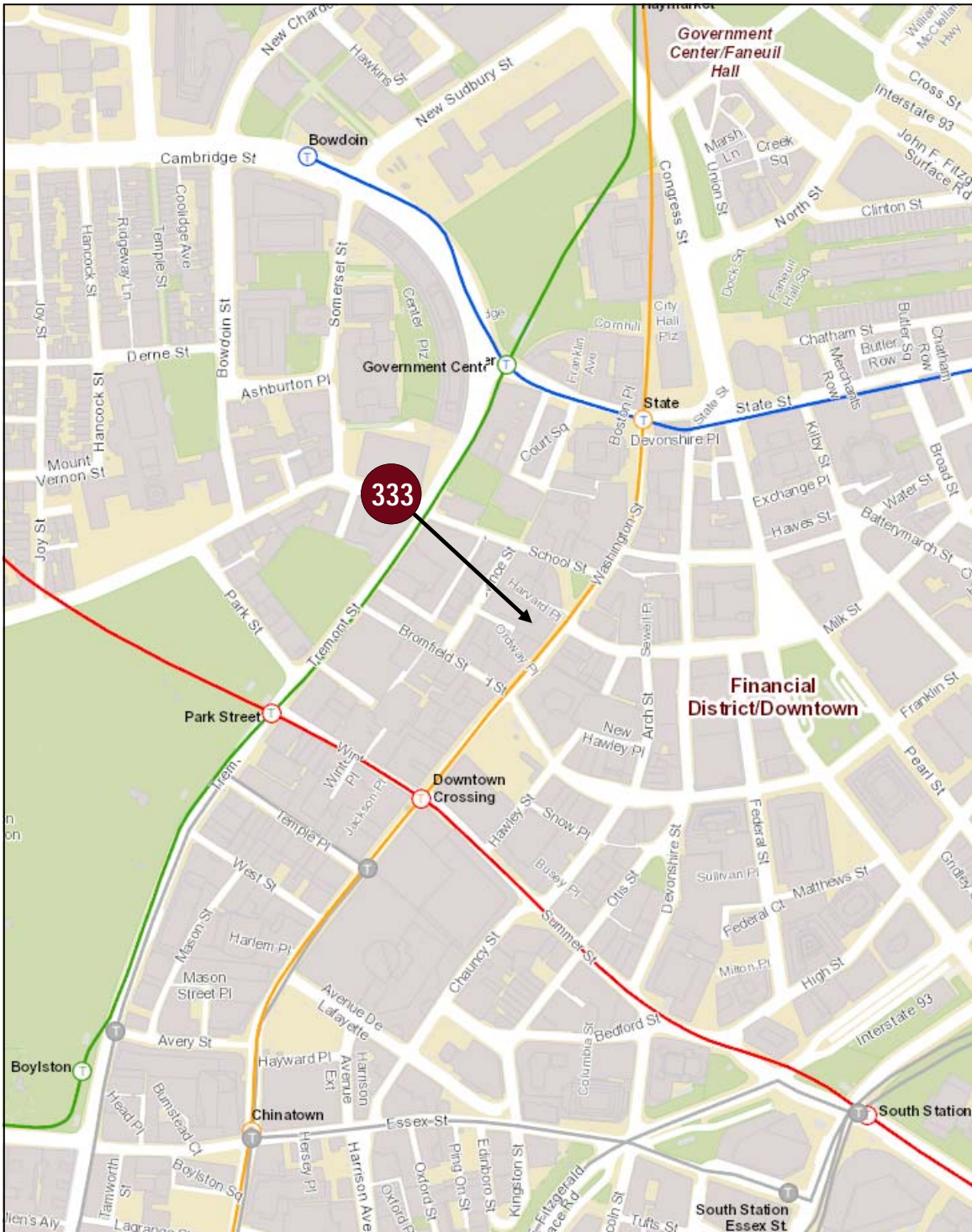

**333 Washington Street Basement Level**  
**Subject Space Size/Location**

*Tenant Reference:* Former Shermans Luggage and Castro Convertibles

*Location:* Downtown Crossing; "The Jewelers Building" situated on Washington and Province Streets between Bromfield and School Streets

*Unit Size/Location:* 11,841 total square feet (sf) - basement space (4 units):

- |  |   |                     |
|--|---|---------------------|
| <ol style="list-style-type: none"> <li>1. 5,176 sf – east side of the basement level (unit 6)</li> <li>2. 1,451 sf – east side of the basement level (unit 8)</li> <li>3. 40 sf – west side of the basement level (unit 9)</li> <li>4. 5,174 sf – west side of the basement level (unit 12)</li> </ol> | } | 6,627 contiguous sf |
|--|---|---------------------|

*Taxes and CAM:* Approximately \$3.25 per square foot

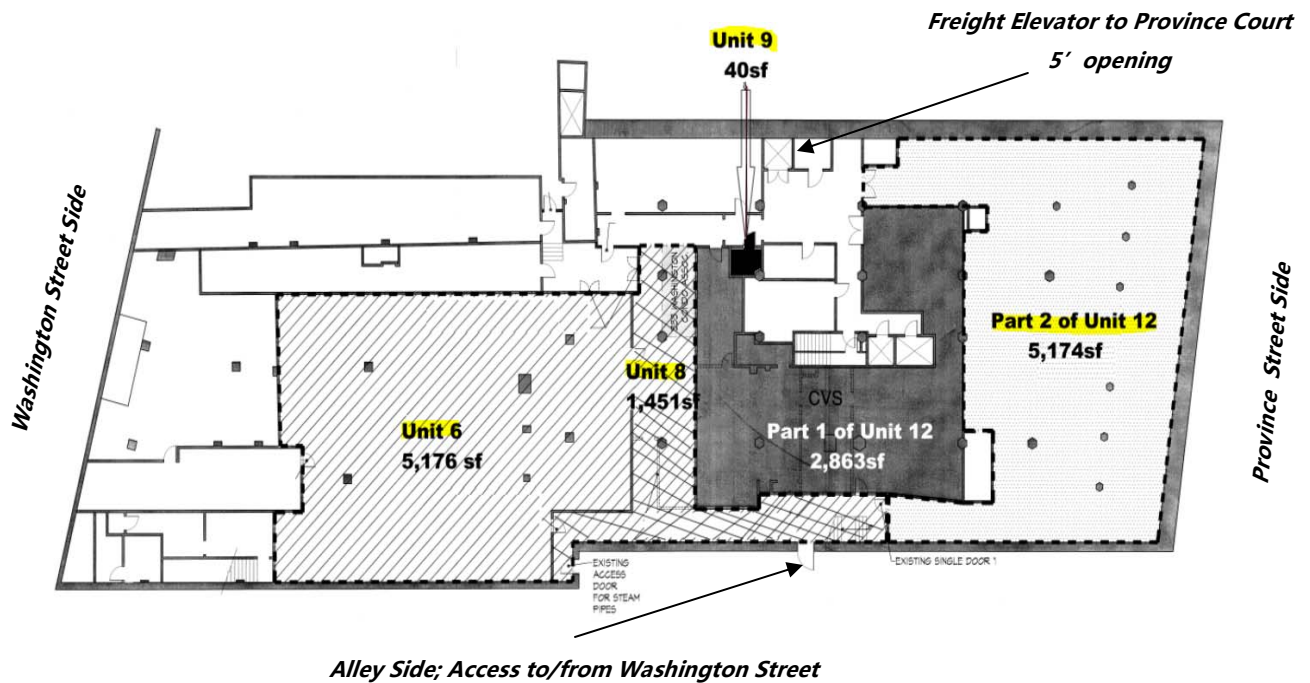

**333 Washington Street Basement Level**  
**Photos**



*Unit 12, Ceilings: 11' -8" to 13' -2"*



*Unit 6, Ceilings: 7' -9" to 10'*



*Freight Elevator, 5' opening*



*Loading Via Freight Elevator off Province Street*