

# Retail Space Available

617 725 0200



# 681 Washington Street Boston, MA 02108

Wine Gallery

Midtown Cultural District;  
Corner of Washington and  
LaGrange Streets

Approximately:

874 rentable sf- Ground Flr

Frontage (estimated):

19' on Washington +  
40' on LaGrange

Ceiling Heights (estimated):

10-12' to the deck

**CRE Brokerage**

Sixty State Street  
Boston, MA 02109

Phone: 617 725 0200  
info@creboston.com

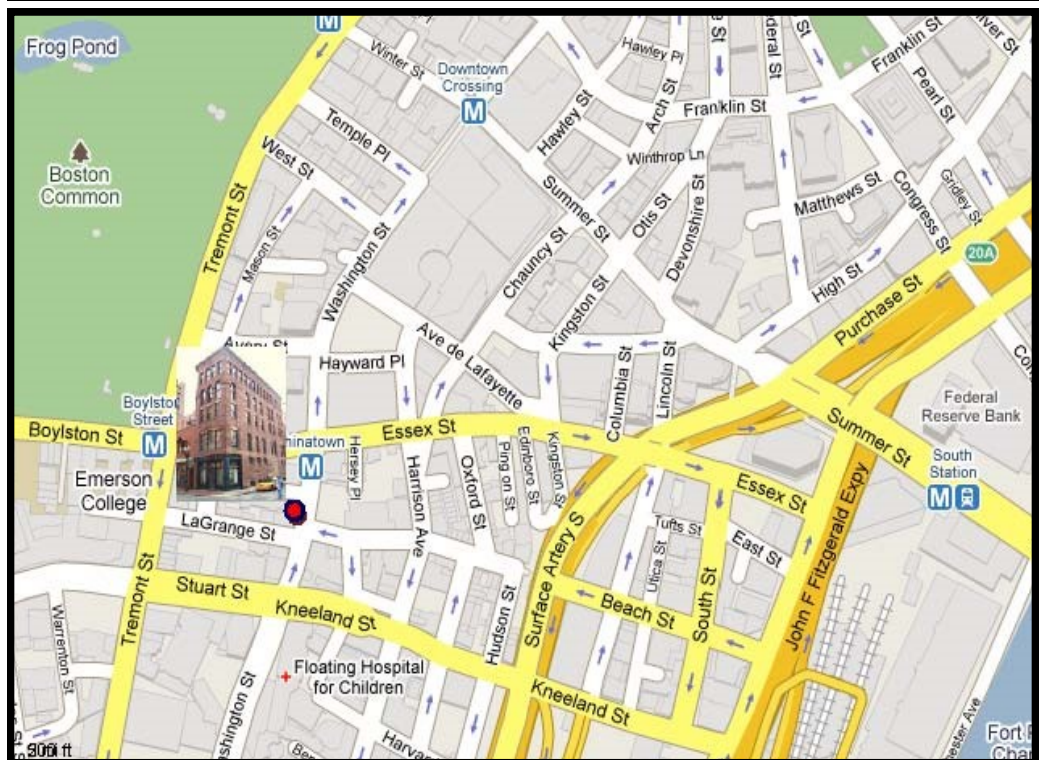

Note: Every effort has been made to furnish the most accurate information available on this property. However, all statements and conditions contained herein are subject to errors, omissions, prior lease, sale or removal from the market without notice.

# Retail Space Available

617 725 0200



Ground Floor Plan  
874 rsf



**CRE Brokerage**

Sixty State Street  
Boston, MA 02109

Phone: 617 725 0200  
joe@creboston.com

# 681 Washington Street Boston, MA 02108

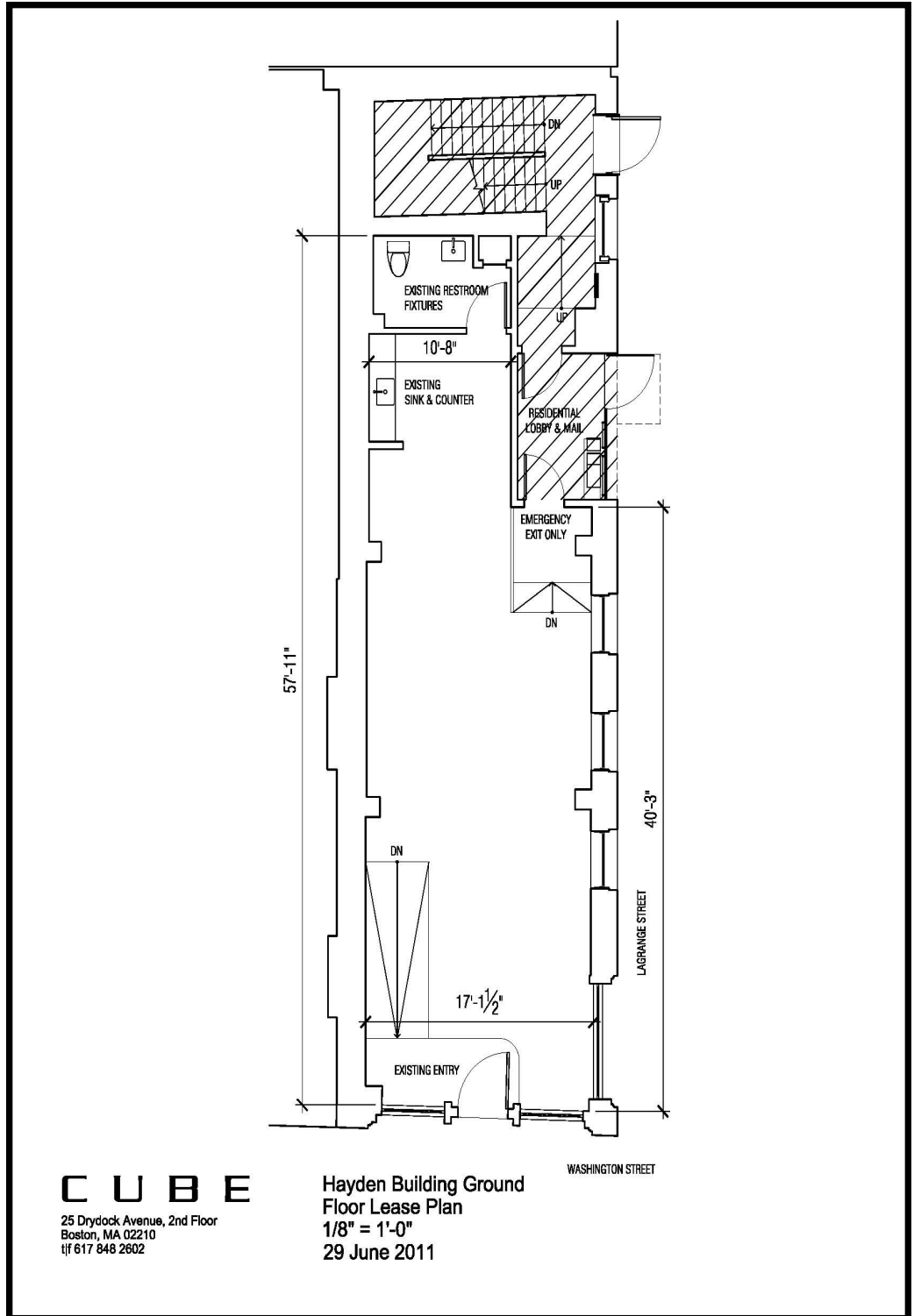

**C U B E**

25 Drydock Avenue, 2nd Floor  
Boston, MA 02210  
tff 617 848 2602

Hayden Building Ground  
Floor Lease Plan  
1/8" = 1'-0"  
29 June 2011

Note: Every effort has been made to furnish the most accurate information available on this property. However, all statements and conditions contained herein are subject to errors, omissions, prior lease, sale or removal from the market without notice.